

TF150AB11-300 F

HIGH POWER ALN TERMINATION

SPECIFICATIONS

FILE: TERMOUT

POWER MAX (WATTS):

150 CW

RESISTANCE

50 OHMS ±5%

FREQUENCY

VSWR

350-450 MHz

1.06:1

869-960 MHz

1.06:1

1805-2000 MHz

1.06:1

RoHS COMPLIANT (BeO FREE)

DIMENSIONS IN BRACKETS INDICATE [mm]

POWER DERATING

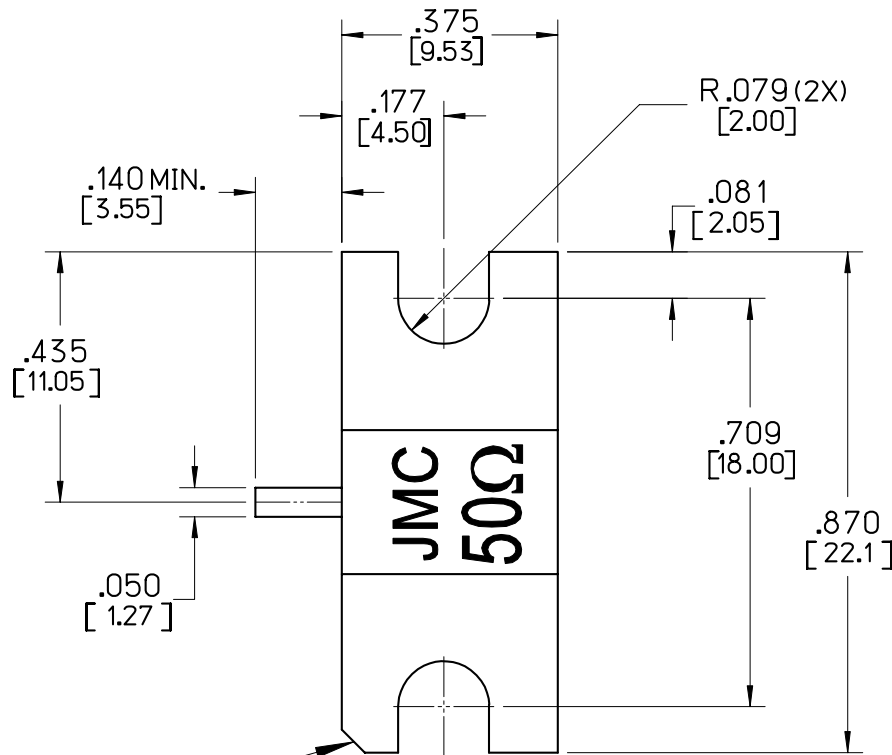
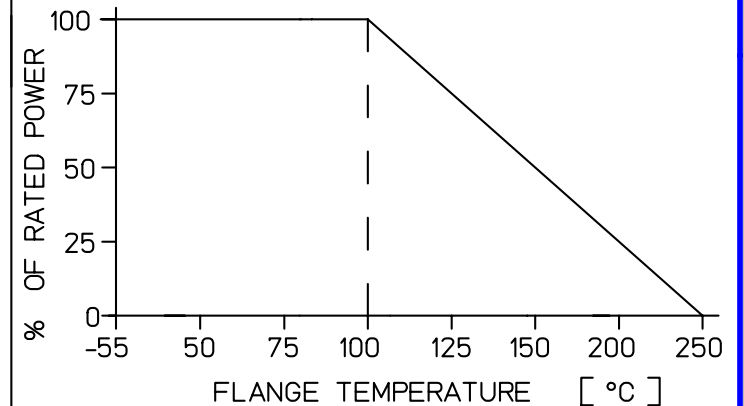

CHAMFER (REF)

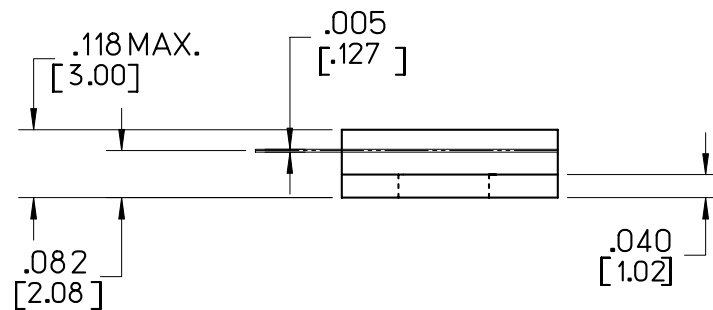

F	10/25/07	MLD	MAI	MAI	000610
E	03/14/07	MLD	MAI	MAI	000520
D	03/02/07	MLD	MAI	MAI	000515
C	02/20/07	MLD	MAI	MAI	000508
B	02/16/07	MLD	MAI	MAI	000506
A	02/16/07	MLD	-	-	000504
LEVEL	DATE	DRN.	CHK.	APP.	ECN

REVISIONS

DRN.	CHK.	APP.	SCALE
MLD	MAI	MAI	3' = 1"
DATE	DATE	DATE	.XX ± .015
02/16/07	02/16/07	02/16/07	.XXX ± .010



JOHANSON MANUFACTURING CORPORATION
 ROCKAWAY VALLEY ROAD, BOONTON, N.J. 07005 (973)334-2676 FAX (973)334-2954
 ELECTRONIC ACCURACY THROUGH MECHANICAL PRECISION