

# TF150AB11-006

# C

## HIGH POWER ALN TERMINATION

SPECIFICATIONS

FILE: TERMOUT

POWER MAX (WATTS):

150 CW

RESISTANCE

50 OHMS ±5%

FREQUENCY

VSWR

350-450 MHz

1.06:1

869-960 MHz

1.06:1

1805-2000 MHz

1.06:1

UP TO 2300 MHz

1.1:1

RoHS COMPLIANT (BeO FREE)

DIMENSIONS IN BRACKETS INDICATE [mm]

REFERENCE CUSTOMER SPEC #9036193

MATERIALS USED IN MANUFACTURE OF UNIT ARE NOT TO BE CHANGED WITHOUT PRIOR CUSTOMER NOTIFICATION

### POWER DERATING

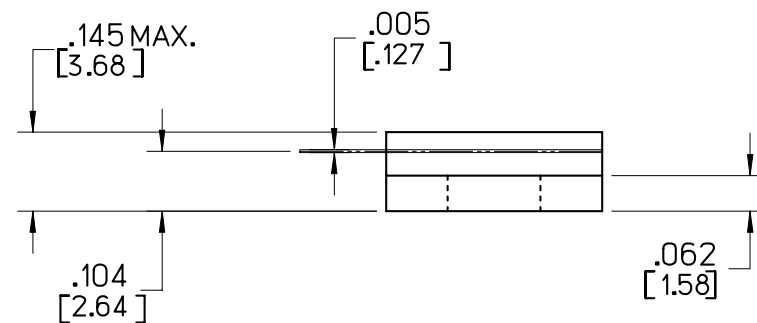
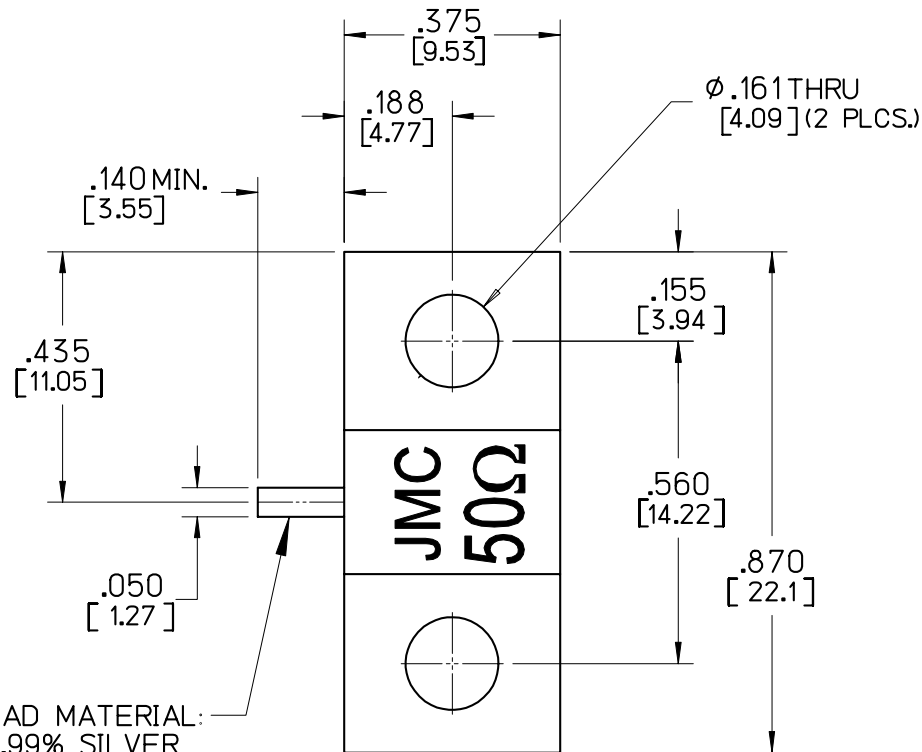
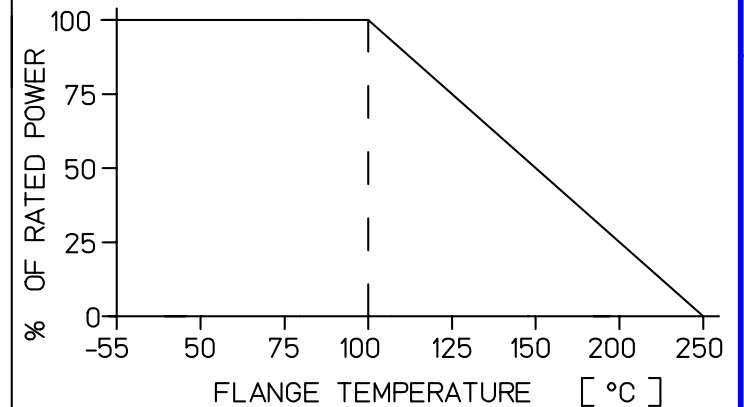

C	11/07/07	MLD	MAI	MAI	000607
B	11/05/07	MAI	MAI	MAI	000614
A	10/24/07	SAF	-	-	000608
LEVEL	DATE	DRN.	CHK.	APP.	ECN

REVISIONS

DRN.	SAF	CHK.	MAI	APP.	MAI	SCALE	3" = 1"
DATE	10/24/07	DATE	10/25/07	DATE	10/25/07	.XX ± .015	.XXX ± .010



**JOHANSON MANUFACTURING CORPORATION**  
 ROCKAWAY VALLEY ROAD, BOONTON, N.J. 07005 (973)334-2676 FAX (973)334-2954  
 ELECTRONIC ACCURACY THROUGH MECHANICAL PRECISION