

HIGH POWER ALN TERMINATION

SPECIFICATIONS | FILE: TERMOUT

POWER MAX (WATTS):	150 CW
RESISTANCE	50 OHMS ±5%
FREQUENCY	VSWR
350-450 MHz	1.06:1
869-960 MHz	1.06:1
1805-2000 MHz	1.06:1
UP TO 2300 MHz	1.1:1
RoHS COMPLIANT (BeO FREE)	
DIMENSIONS IN BRACKETS INDICATE [mm]	

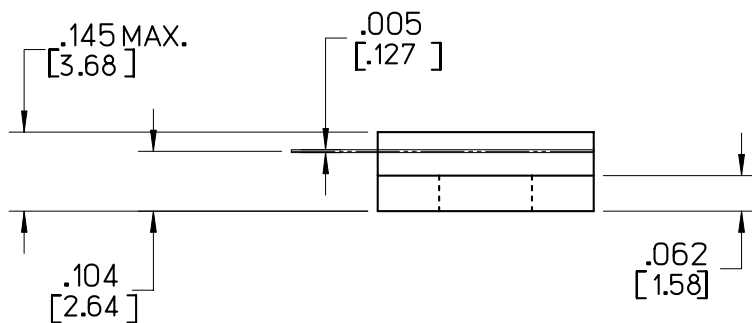
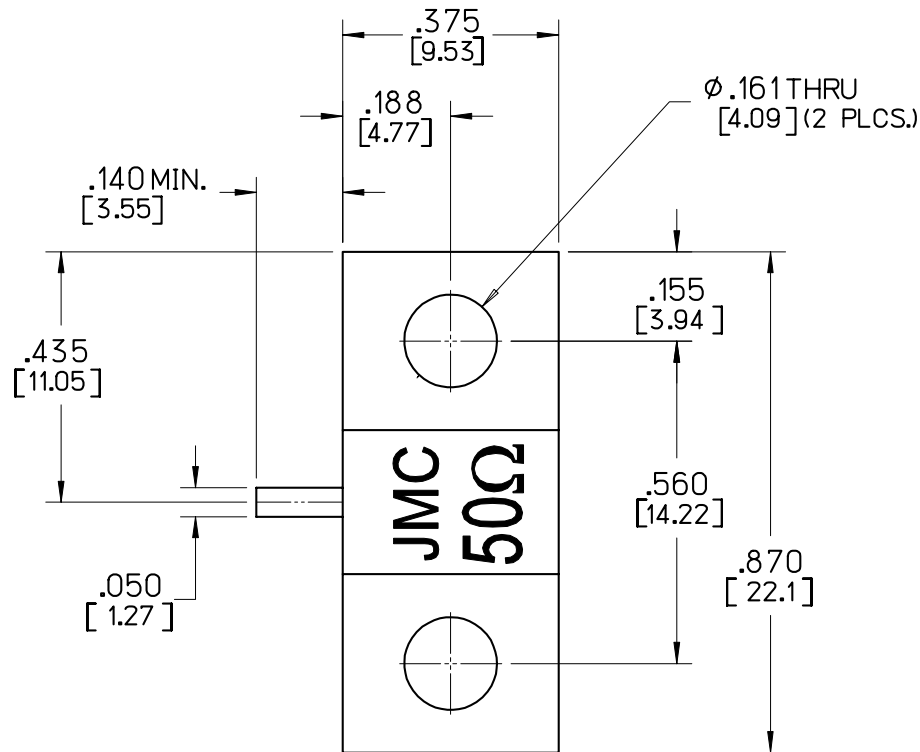

POWER DERATING

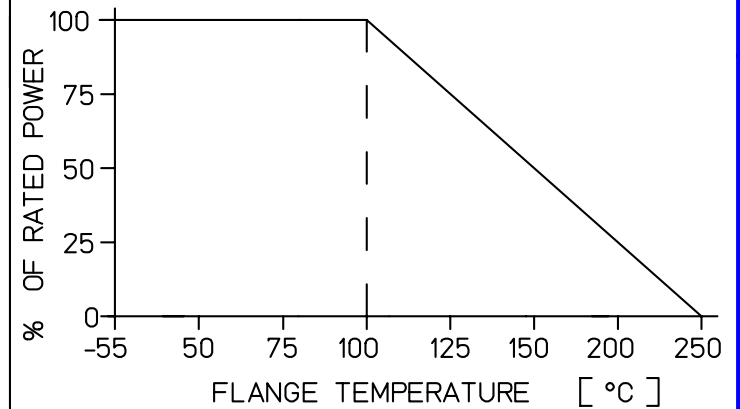

A	09/05/08	MLD	-	-	000705
LEVEL	DATE	DRN.	CHK.	APP.	ECN
REVISIONS					
DRN.	MLD	CHK.	MAI	APP.	MAI
DATE	DATE	DATE	DATE	DATE	SCALE
09/05/08	09/08/08	09/08/08	09/08/08	09/08/08	.XX ± .015 .XXX ± .010



JOHANSON MANUFACTURING CORPORATION
 ROCKAWAY VALLEY ROAD, BOONTON, N.J. 07005 (973)334-2676 FAX (973)334-2954
 ELECTRONIC ACCURACY THROUGH MECHANICAL PRECISION